

Fenton Intake Installation Kit Instructions part #3687540B

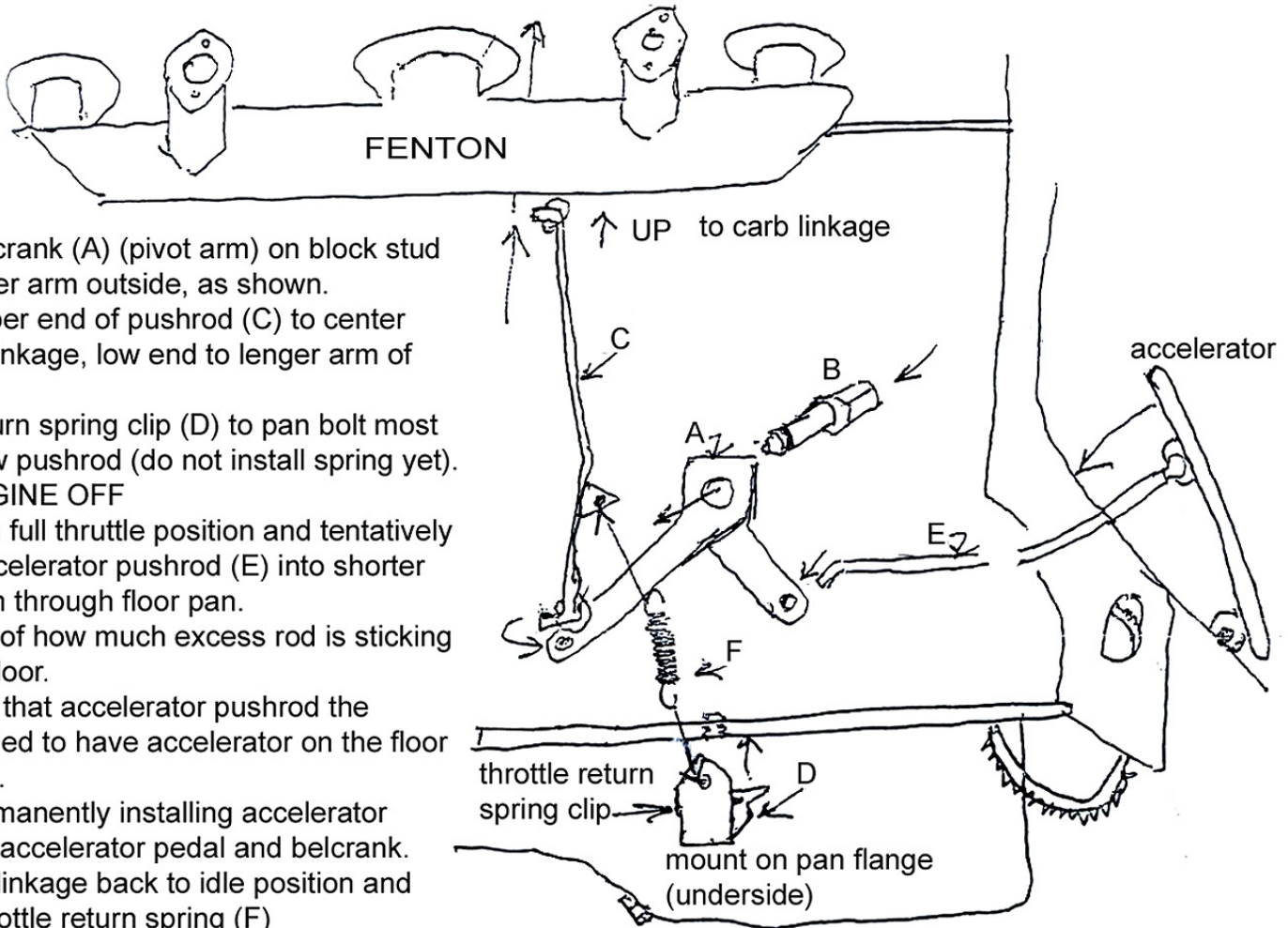

1. Mount bellcrank (A) (pivot arm) on block stud (B) with longer arm outside, as shown.
2. Attach upper end of pushrod (C) to center arm of carb linkage, low end to longer arm of bellcrank (A).
3. Attach return spring clip (D) to pan bolt most directly below pushrod (do not install spring yet).
4. WITH ENGINE OFF

Fix linkage in full throttle position and tentatively install the accelerator pushrod (E) into shorter bellcrank arm through floor pan.

Make a note of how much excess rod is sticking through the floor.

Now shorten that accelerator pushrod the amount needed to have accelerator on the floor at full throttle.

5. Finish permanently installing accelerator pushrod into accelerator pedal and bellcrank. Release the linkage back to idle position and install the throttle return spring (F)
6. Operate the assembly from inside of the car (using accelerator pedal) and under the hood by hand to make sure everything transitions from idle to full throttle without rubbing, binding or hanging up, then start your engine.